

Smart Heating Thermostat

HT-CS03

This is a smart APP controlled WIFI programmable thermostat which works with Amazon Alexa & Google Assistant voice control. According to the present temperature, the thermostat will automatically start or stop the controlled object such as valve, heating floor, heating wall, electric heater etc. This thermostat has an elegant, sleeker design with a 4.3" LCD touch screen ensuring an excellent user experience of temperature control.



Functions

- Attractive 4.3inch Color Touch Screen Operation
- WIFI Remote Control, compatible with Amazon Alexa and Google Assistant Voice Control
- Adjustable Manual Mode, Eco Mode and Auto Mode
- 7 Days 4 period programmable
- Internal Sensor & External sensor
- Child Lock
- Open window detection
- Frost Protection
- High Temp. Protection
- CE, ROHS certificated

Technical Data

Voltage	- 230V, 50/60Hz	Backlight	- colorful
Current	- 3A	Sensor	- NTC 10Kohms at 25°C
Temp. Setting Range	- 5~35°C	Accuracy	- $\pm 0.5^{\circ}\text{C}$
Ambient	- 0~50°C	Protection Class	- IP30
Relative Humidity	- 85%	Housing	- ABS fire retardant plastic

Display

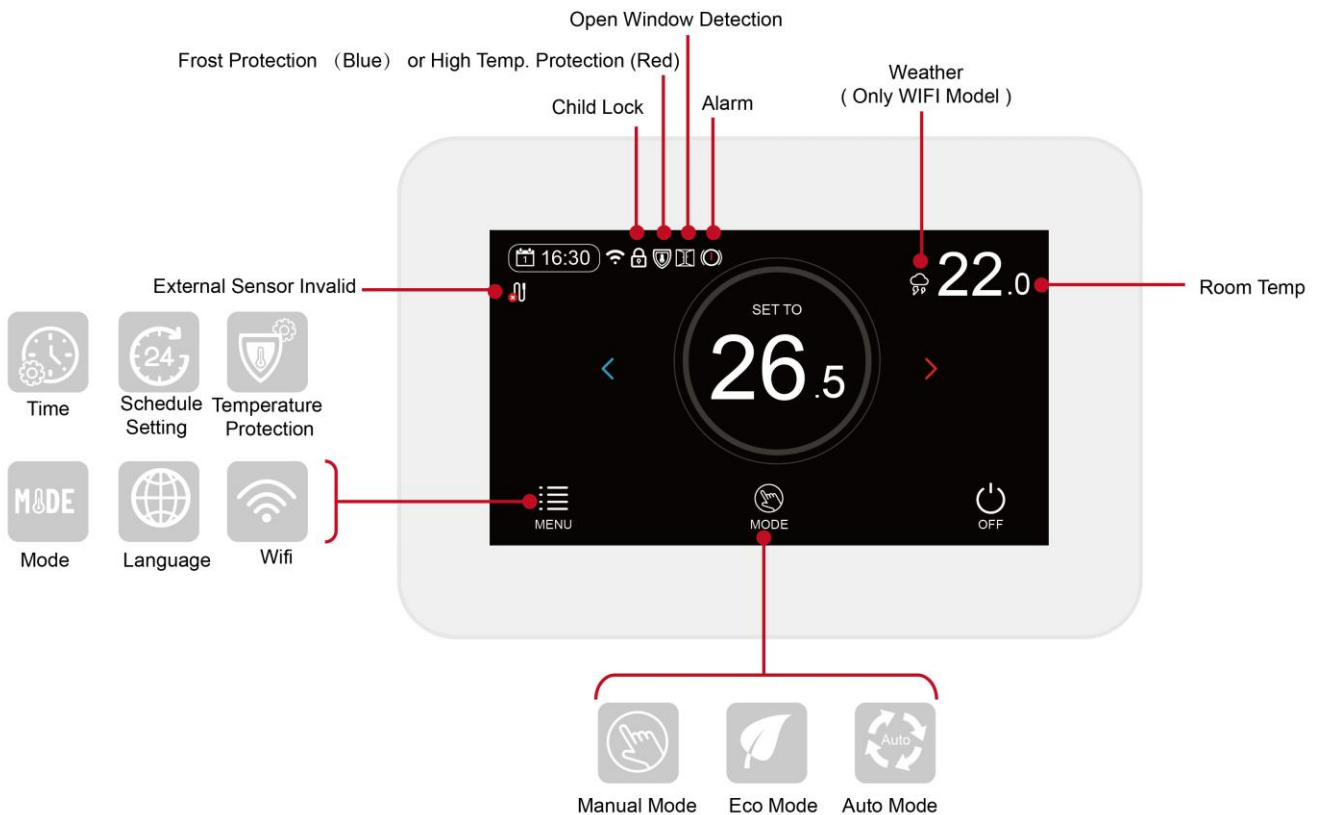



WIFI Connection

Please download "Smart life" APP from Google play or app store. Once download, the app will ask you to register your device. Enter your email, select the country you live in and create a password for your Smart life account.



You can connect to app by Bluetooth scan or wifi connection, Bluetooth is more recommended.

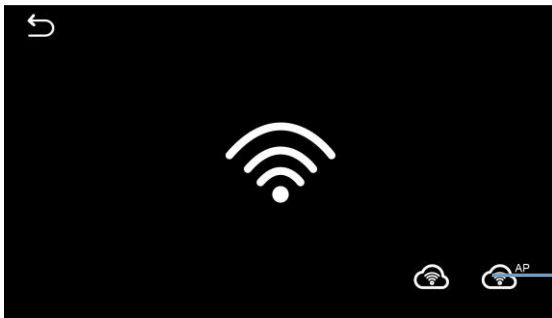

- 1) Enable Bluetooth function on your phone
- 2) Add device by press "+" button at top right corner
- 3) Press **Menu**, press WIFI icon to enter connection page. Click ,  icon start flashing.



Press here to start connection



- 4) App is searching for nearby Bluetooth device. Press “ Add “
- 5) Choose Wi-Fi and enter password
- 6) Wait till device add successfully

2.4Ghz Wi-Fi Connection Method:

1. Add device by press “+” button at top right corner
2. Press “Small Home Applicant” and select “Thermostat (Wi-Fi)” on the list.
3. Select 2.4Ghz Wi-Fi Network and enter password, and press “Next”.
4. Press **Menu**, Press WIFI icon to enter connection page. Click ,  icon start flashing.
5. Press “Next” on app, tick “Blink Quickly” on phone to add device.
6. Wait a moment till app indicate “Added successfully”, at this page you can rename the device. And then tap “ Done” at the up right corner, the app will auto change to main page

Date & Time Setting

The date and time setting is automatically updated when the thermostat is connected to Wi-Fi via the application. If this does not happen, follow the procedure below:

Press Menu, choose  button to enter setting page. Set the date and time by pressing the  and  buttons.

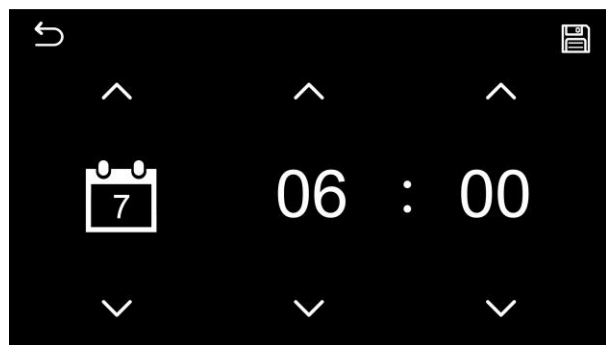
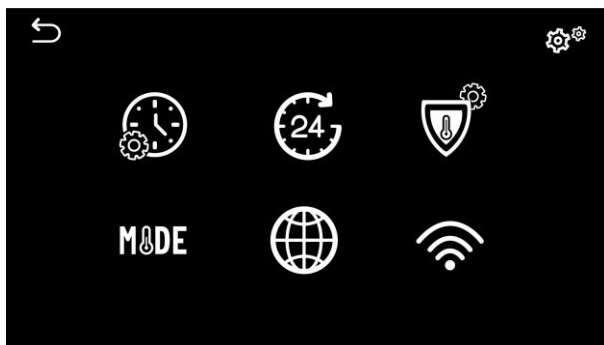

Schedule Setting

When AUTO mode selected, thermostat will auto work accordingly to preset time and temperature per day. You may change schedule setting from APP (preferred) or from thermostat by following.

Press **Menu**, then click  icon, the weekly sehcdule will show on display. Click desired day column to edit schedule.

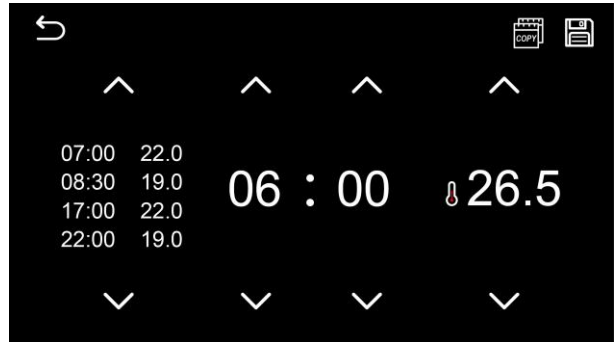

You can further copy a day schedule to other days quickly by pressing  at top left corner, then select the desired days to complete schedule setting.

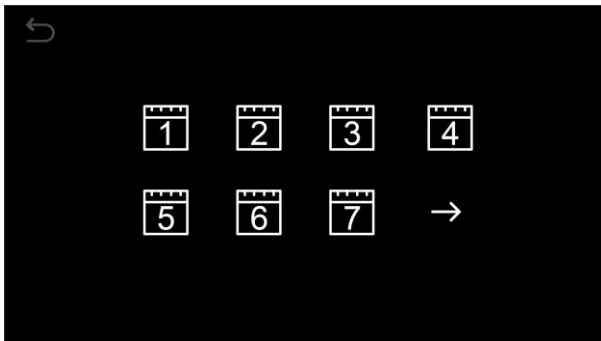



Mode Temperature Setting

When mode selected, thermostat will work accordingly to pre-set temperature. Manual mode default set-point is 22 °C, Eco mode default set point is 19 °C. You can change set-point by following.

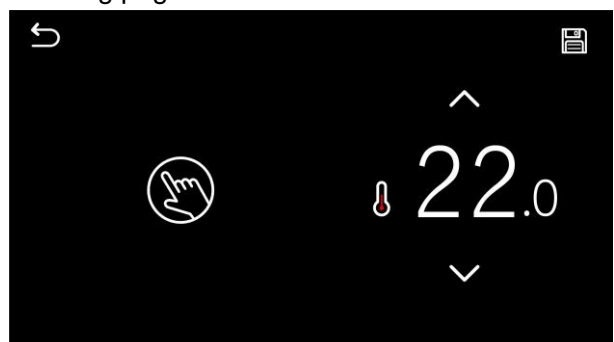
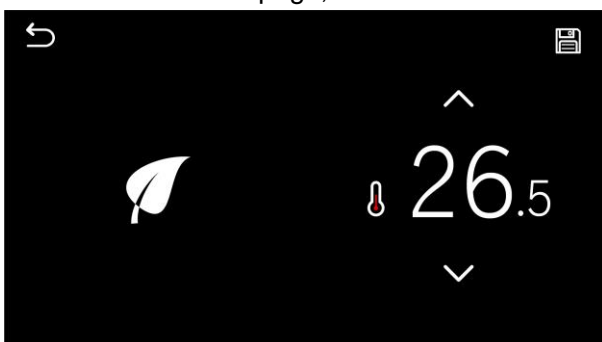
Press **Menu** at main page, click **MODE** icon to enter setting page.



Note:



When thermostat work in any mode, if you change values by pressing  and  button at main page, those changes only work as temporarily set-point, those will not be kept for next time usage.

Frost Protection & High Protection Setting

Frost Protection: This is the temperature maintained when the thermostat is in Frost Mode. When room temperature detected below set-point (default 5°C), thermostat will turn on heating to anti-frost.

High Protection: This function is available when both internal & external sensor used. You can set a floor limiting temperature between 10-35°C (32°C is the default setting). When thermostat in Overheat mode, the screen will show icon“(❗)”, only when detected floor temperature 4 °C lower than high protection set point, thermostat will exist overheat mode, and resume to previous working mode.

Frost Protection and High Protection default set point can be changed by following:

Press Menu at main page, click  icon to enter setting page. Set the desired set-point by pressing the  and  buttons.

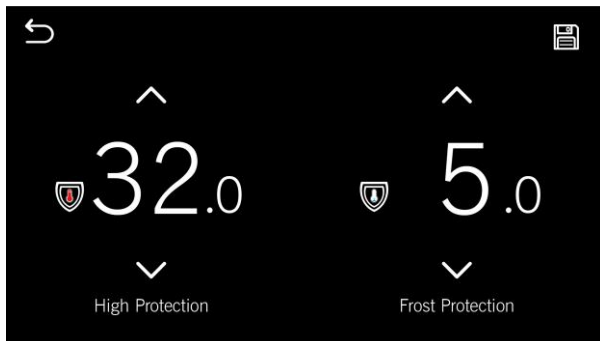

Parameter setting

For Enter parameter setting, press **Menu** button, then press setting icon .

FCU Room Thermostat

HT-CS03

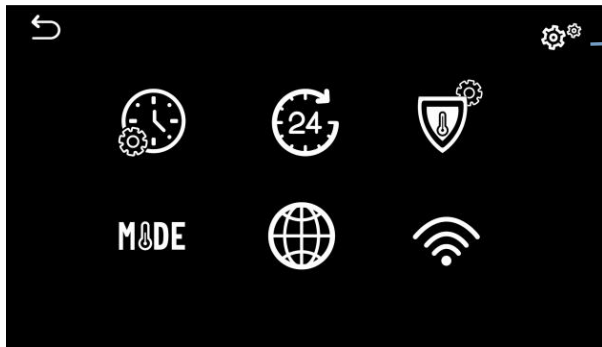

Press setting button here

<u>Menu</u>	<u>Description</u>	<u>Range</u>	<u>Default</u>
Page 1	Temp. Calibration	-10 °C ~10°C	0°C
	Set Point Max.	5 °C ~35°C	35°C
	Set Point Min.	5 °C ~35°C	5 °C
	Child Lock	Lock/Unlocked	Unlock
Page 2	Dead Zone	0°C ~3°C	0°C
	NTC Select	I only; E only; I or E; I & E	I & E
	Relay Output	NO/NC	NO
	External Sensor	Read Only	
Page 3	Open Window Function	Disable Enable	Disable
	OWD Detect Time	2~30mins	15mins
	OWD Drop temp. select (within detect time)	2.3.4°C	2°C
	OWD Delay time select (Return to previous working status)	10~60min	30mins
Page 4	Min. Backlight (Brightness of Standby Status)	0%~100%	15%
	Backlight Time (Backlight off Time after Operation)	10s~180s	30 s
Page 5	Reset		

Wiring Diagram

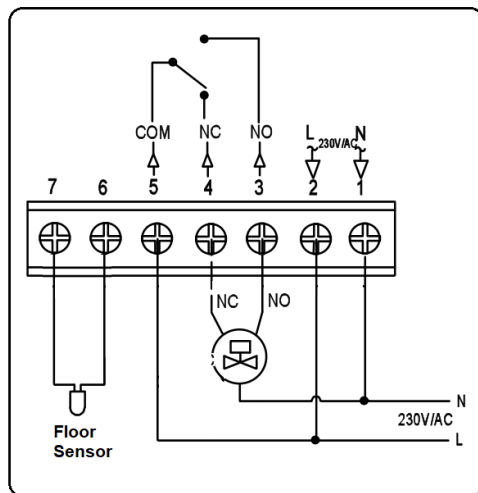

230Vac output (jumper COM&L)

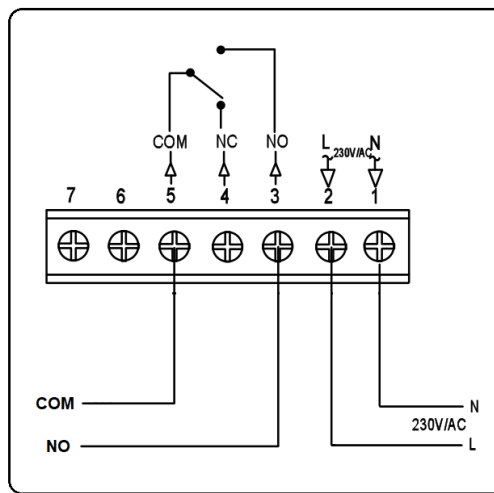

Voltage-free output

Installation Procedure



DO

Mount the thermostat at eye level.

Read the instructions fully so you get the best from our product.



DON'T

Do not install near to a direct heat source as this will affect functionality.

Do not push hard on the LCD screen as this may cause irreparable damage.

The thermostat is designed to be flush mounted and requires a back box of 36mm (minimum depth) to be sunk into the wall prior to installation.

Step 1

Using a small screwdriver, slightly loosen the screw from the bottom face of the thermostat. Then carefully separate the front half from the back plate.

Step 2

Place the thermostat front somewhere safe. Terminate the thermostat as shown in the diagram

Step 3

Screw the thermostat back plate securely into the back box.

Step 4

Clip the front of the thermostat onto the back plate

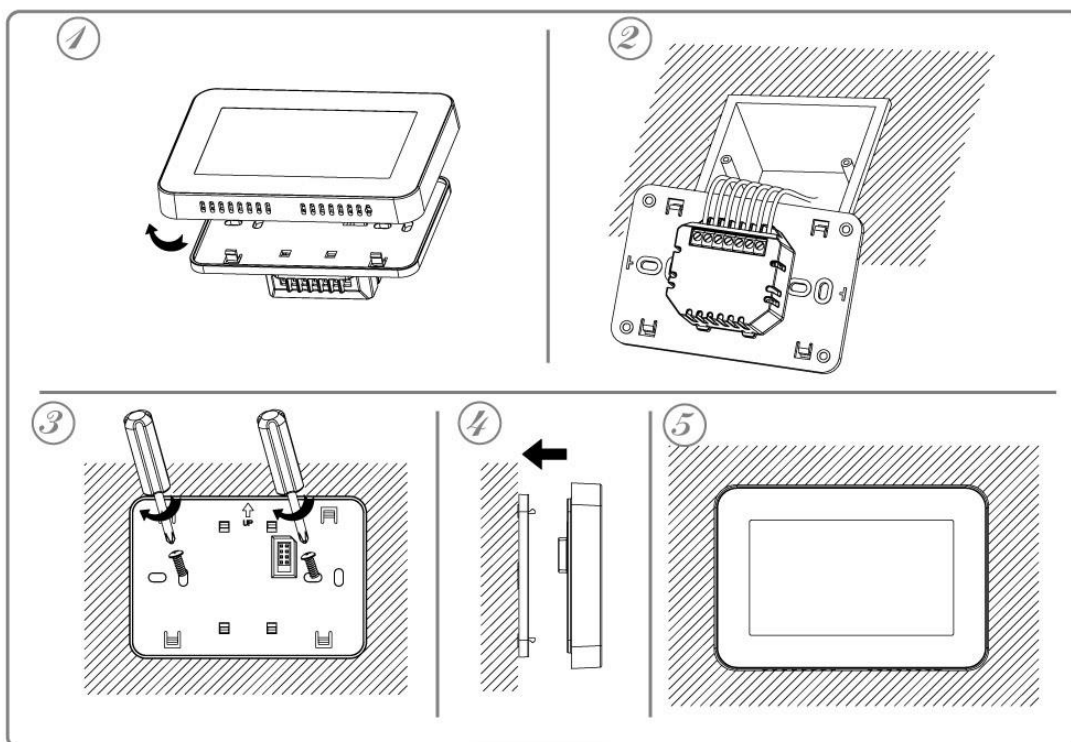

Size

